

# SEGMENTAL CASING CLAMPS

A quality casing clamp is the only piece of equipment that can reduce the likelihood of losing a costly string of segmental casing, down a bored piling shaft. Without a suitable casing clamp, the security of your segmental casing is at risk and could cause huge setbacks on both your jobsite and on your casing investment!

Pinnacle Drilling Products can supply locking Casing Clamps in a range of various casing sizes, in order to clamp down on your casing investment. From specifically sized casing diameters to adjustable casing clamps that will secure a multitude of casing diameters, we have several options for your clamping requirements.

---

## Fixed Diameter Manual Casing Clamp

Pinnacle Drilling Products can manufacture specifically sized casing clamps depending on your desired casing diameters. We offer several clamp designs that range in size and strength, ensuring compatibility with the vertical load weight in which you are drilling.

## Quadra Clamps

Pinnacle's new line of innovative adjustable casing clamps - "Quadra-Clamp" has gained serious traction in the Kelly bar drilling industry over the past few years and continues to grow in popularity and demand. The Quadra-Clamp line is offered in three sizing options:

- Quadra Clamp 1000 - Casing Range: 620mm - 1000mm (Capacity up to 54,000 lbs)
- Quadra Clamp 1300 - Casing Range: 1000mm - 1300mm (Capacity up to 82,000 lbs)
- Quadra Clamp Custom - Custom clamp sizes and ranges available upon request

## FEATURES

- Variable clamping diameter
- Automatic casing release on lift
- Automatic re-clamp on drop
- Adjustable/Removable feet
- Ground spikes
- Easy to use and maintain
- No hydraulics required



# SEGMENTAL CASING CLAMPS

FIXED DIAMETER MANUAL CASING CLAMPS

QUADRA CLAMPS

- QUADRA CLAMP 1000
- QUADRA CLAMP 1300
- QUADRA CLAMP CUSTOM

## Quadra-Clamp 1000

Adjustable Casing Clamp  
620mm – 1000mm  
P/N: 5237-0 Rev1  
Datasheet: 2021-01-20

### Highlights

- Variable clamping diameter
- Automatic casing release on lift
- Automatic re-clamp on drop
- Adjustable feet
- Ground spikes
- Easy to use and maintain
- No hydraulics required

### Specifications

Diameter Range:	620mm – 1000mm
Capacity:	Up to 54,000 lb (24,545 kg)
Dimensions:	69.7" x 69.7" x 19.9" (1770mm x 1770mm x 505mm)
Ship Weight:	1750 lb (795 kg)

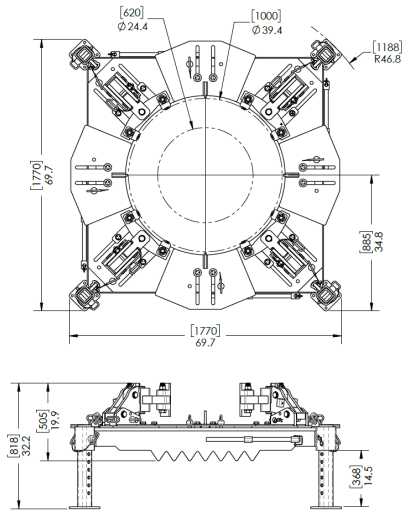

### Casing Clamp 5237-0 Ratings

Diameter (mm)	Weight Rating @ Dia. (lb)	Weight Rating @ Dia. (kg)	Leffer Standard DBL Wall		Bauer Standard DBL Wall	
			*Weight (kg/5m)	*Depth (m)	*Weight (kg/5m)	*Depth (m)
620	35,100	15,955	1970	40.5	1747	45.7
640	36,554	16,615	2030	40.9	-	-
660	38,008	17,276	2095	41.2	-	-
700	40,915	18,598	2230	41.7	-	-
720	42,369	19,259	2305	41.8	-	-
750	44,550	20,250	2425	41.8	2131	47.5
800	48,185	21,902	3010	36.4	-	-
880	54,000	24,545	2860	42.9	2520	48.7
900	54,000	24,545	2930	41.9	-	-
1000	54,000	24,545	3525	34.8	2877	42.7

\*Actual casing weights and max depths may vary based on manufacturer. Do not exceed weight ratings.

## Quadra-Clamp 1300

Adjustable Casing Clamp  
1000mm – 1300mm  
P/N: 5246-0 Rev1  
Datasheet: 2021-01-20

### Highlights

- Variable clamping diameter
- Automatic casing release on lift
- Automatic re-clamp on drop
- Adjustable feet
- Ground spikes
- Easy to use and maintain
- No hydraulics required

### Specifications

Diameter Range:	1000mm – 1300mm
Capacity:	Up to 82,000 lb (37,273 kg)
Dimensions:	95.5" x 88.0" x 24.2" (2527mm x 2235mm x 613mm)
Ship Weight:	4102 lb (1865 kg)

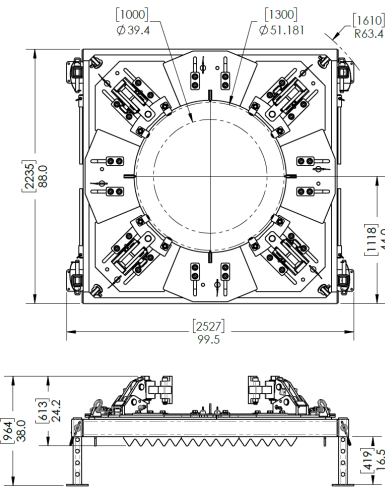

### Casing Clamp 5246-0 Ratings

Diameter (mm)	Weight Rating @ Dia. (lbs)	Weight Rating @ Dia. (kg)	Leffer Standard DBL Wall		Bauer Standard DBL Wall	
			*Weight (kg/5m)	*Depth (m)	*Weight (kg/5m)	*Depth (m)
1000	82,000	37,273	3525	52.9	2877	64.8
1080	82,000	37,273	3800	49.0	-	-
1180	82,000	37,273	4185	44.5	3787	49.2
1200	82,000	37,273	4280	43.5	3870	48.2
1300	82,000	37,273	4620	40.3	4184	44.5

\*Actual casing weights and max depths may vary based on manufacturer. Do not exceed weight ratings.

