

# ROCK & DIRT AUGERS

With the ever-increasing power of today's drilling rigs, a high-quality, well-built auger is a necessity. Pinnacle drilling products supplies a diverse and suitable selection of rock, dirt, and clay augers in a wide range of diameters and configurations.

---

## Rock Augers

Pinnacle's ground-breaking rock augers are engineered to meet the increasing demand of today's high powered, hydraulic drilling rigs. With optimal cutting structures, you gain faster penetration rates through consolidated or fractured rock. Take your durability one step further and add wear protection to increase the lifespan of your dirt or rock augers.

## Dirt Augers

Fabricated with the highest quality steel, these dirt augers are tough, durable, and will make a valuable addition to your jobsite. Designed to cut through soil, clay, sand and even some lightly fractured rock. Skirting option available upon request. Pinnacle Drilling Products stocks and supplies Rock and Dirt Augers ranging in size from 12" to 12' in diameter.

## What Can Be Modified?

The following modifications can be made to all augers, as per your needs and requirements:

- Flighting Thickness
- Multiple Flights
- Flighting Pitch
- Overall Length (OAL)
- Steel Grade
- Hardening
- Pilot
- Teeth & Holders
- Tooth Angles
- Kelly Box and Stem



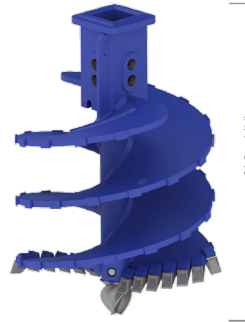
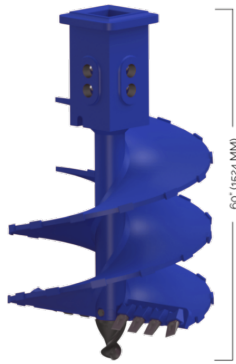

### Dirt Auger Specifications

Commonly Requested Diameters:	14" - 144"*
Type:	Type 6
Cut:	DC/DF, DC/SF, SC/SF
Kelly Boxes:	All boxes made to customer specifications
Center Shaft:	4" OD - 12" OD
» Sold shaft available in some sizes	
Flight:	1" - 2" thick available
» All flight ID is beveled for better weld penetration	
Wear Protection:	Hard surface outer edge

\*Smaller diameters available based on Kelly box size/custom sizes greater than 144".

### Rock Auger Specifications

Commonly Requested Diameters:	16" - 144" *
Cut:	DC/DF, DC/SF, SC/SF, TC/TF
Kelly Boxes:	All boxes made to customer specifications
Center Shaft:	4" OD - 12" OD
» Sold shaft available in some sizes	
Flight:	1" - 2" thickness available
» All flight ID is beveled for better weld penetration	
» Laminate flight on all augers 30" or larger	
Wear Protection:	Wear pads
» 2" x 3" x 1/2" (39302)	

\*Smaller diameters available based on Kelly box size/custom sizes greater than 144".

### Dirt Auger Wear Parts

Teeth:	201 Tooth (34100)
Holder:	W0-5 Holder (36010)
Pilots:	JM-08 Pilot w/2 1/2 sq (40470) JM 8" Pilot w/4" sq (40260) JM 10" Pilot w/4" sq (40262) JM 12" Pilot w/4" sq (40264)

### Wear Items

.990 Rock Series	
Wear Parts:	.990 Standard (30122) .990 Dragon's Tooth® (30145) .990 Tri-holder (32042) .990 Pilot 2½" Square (40205)

38mm Rock Series	
Wear Parts:	B47K19LK80-H (30182) 38mm Dragon's Tooth® (30188) 38mm Tri-holder* (32064) RP-4 Machined Pilot (40285)

\*All .990 and 38mm rock augers are manufactured with Tri-holders.

\*\*Smaller conical teeth available upon request.

